

Read all instructions BEFORE assembly and USE of product.
KEEP INSTRUCTIONS FOR FUTURE USE.

newton[®]

Mini Crib with Mattress

Model 8430 Instruction Manual
Model 1350 Mini Crib Mattress

Scan below
for quick video
assembly guide:

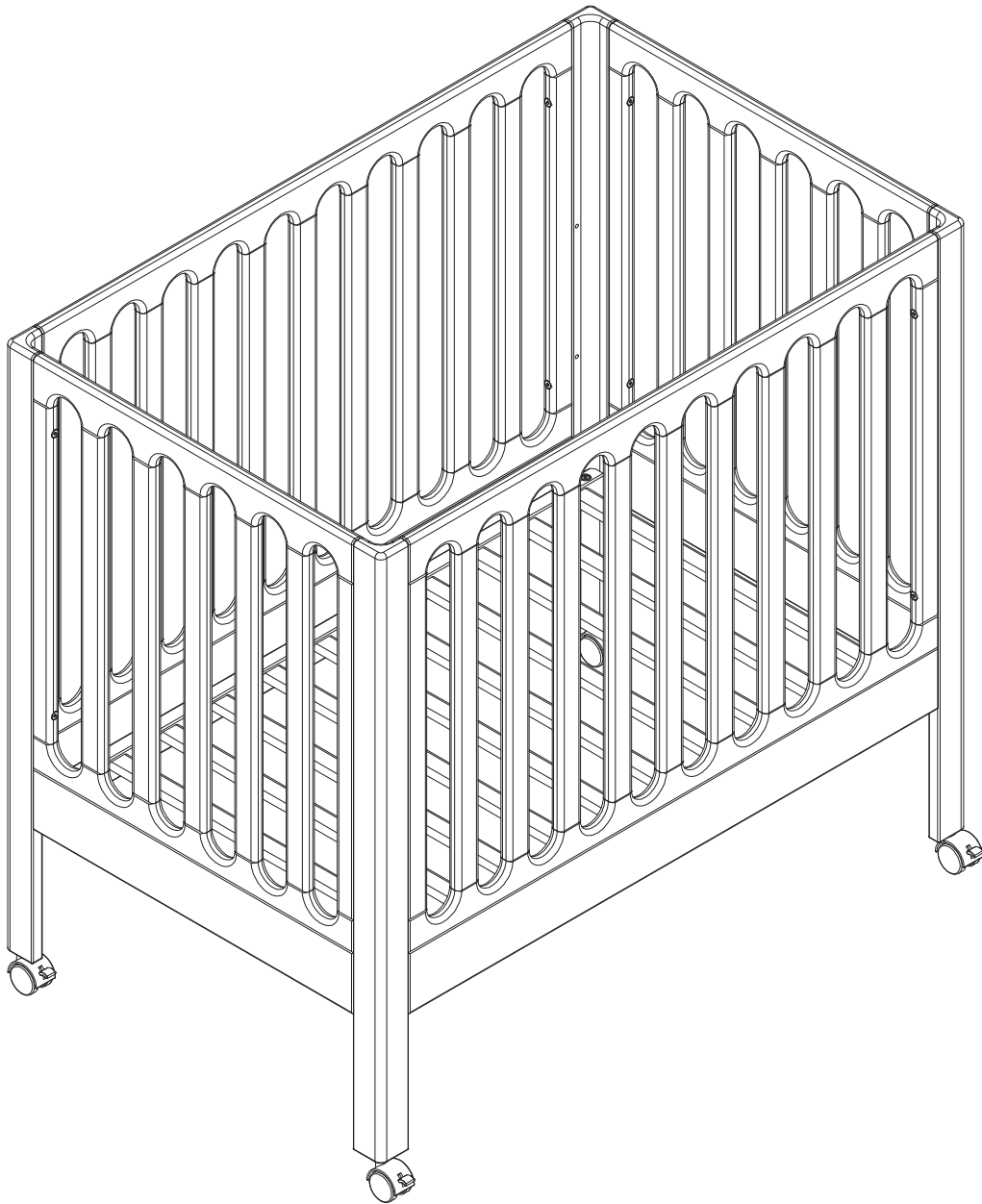

Any questions? Please feel free to contact us at (800)686-3986
or info@newtonbaby.com. We're always happy to help.

MAN5000-20240522

WARNING

Read all instructions BEFORE assembly and USE of product. KEEP INSTRUCTIONS FOR FUTURE USE.
Failure to follow these warnings and the instructions could result in serious injury or death.

● Infants can suffocate:

- In gaps between a mattress too small or too thick and product sides
- On soft bedding
- NEVER add a mattress, pillow, comforter, or padding.
- Use ONLY mattress provided by Newton Baby, Inc. which must be at least 37.75 in. long by 23.75 in. wide and not more than 3 in. thick.
- The product must be fully erected prior to use.

To reduce the risk of SIDS, pediatricians recommend healthy infants be placed on their back to sleep, unless otherwise advised by your physician.

- Discontinue use of the product when child is able to climb out or reaches the height of 35 in. (890 mm).

Always provide the supervision necessary for the continued safety of your child. When used for playing, never leave child unattended.

- Strings can cause strangulation! Never place items with a string around a child's neck such as hood strings or pacifier cords. Never suspend strings over product or attach strings to toys.
- Never place product near a window where cords from blinds or drapes can strangle a child.
- Child can become entrapped and die when improvised netting or covers are placed on top of product. Never add such items to confine child in product.
- When child is able to pull to standing position, set mattress/base to lowest adjustment position and remove bumper pads, large toys, and other objects that could serve as steps for climbing out.
- Never use this product if there are any loose or missing fasteners, loose joints, broken parts, or torn mesh/fabric.
- Check before assembly and periodically during use.
- Contact Newton Baby, Inc. for replacement parts. Never substitute parts.
- Never use plastic shipping bags or other plastic film as mattress covers not sold and intended for that purpose. They can cause suffocation.
- Never use a water mattress with this product.
- If refinishing, use a nontoxic finish specified for children's products.

WARNING

WHEN USED AS A TODDLER SOFA

ONLY use as a toddler sofa with the mattress support in the lowest height adjustment setting.

NEVER use with children younger than 2 years old. Use ONLY with older children who can get in and out of this product configuration without help. NEVER use in this mode for sleep.

NEVER use bed with children younger than 15 months or greater than 50 lbs (22.7 kg).

Parts List

Check that all parts listed below are included in your package.
If there are any missing parts, contact Newton Baby for replacements before use.

Parts Not to Scale

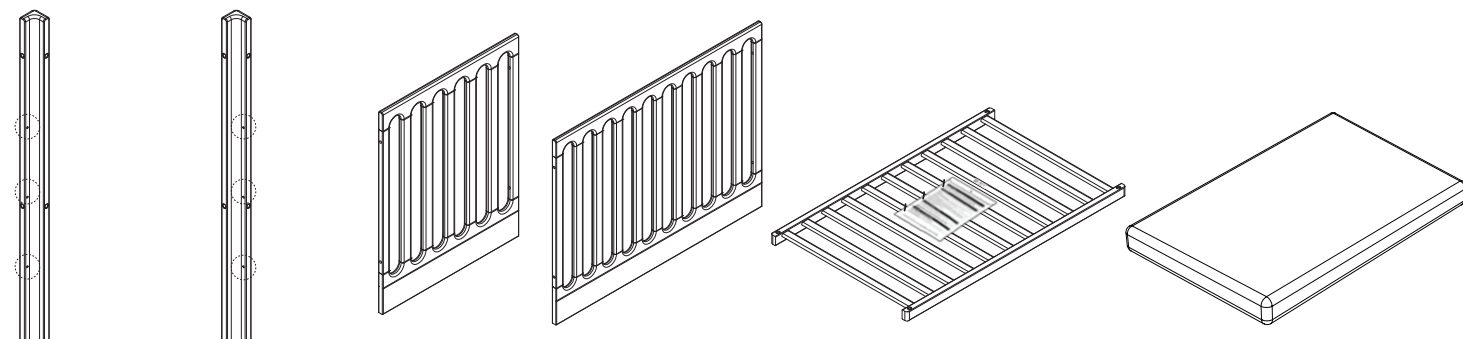

A x 2
Corner Post
(Height
Adjustment
Holes on
Left Side)

B x 2
Corner Post
(Height
Adjustment
Holes on
Right Side)

C x 2
Short Panel

D x 2
Long Panel

E x 1
Mattress Support
(**KEEP ENVELOPE
ATTACHED TO CRIB**)

F x 1
Mattress
(shipped
separately)

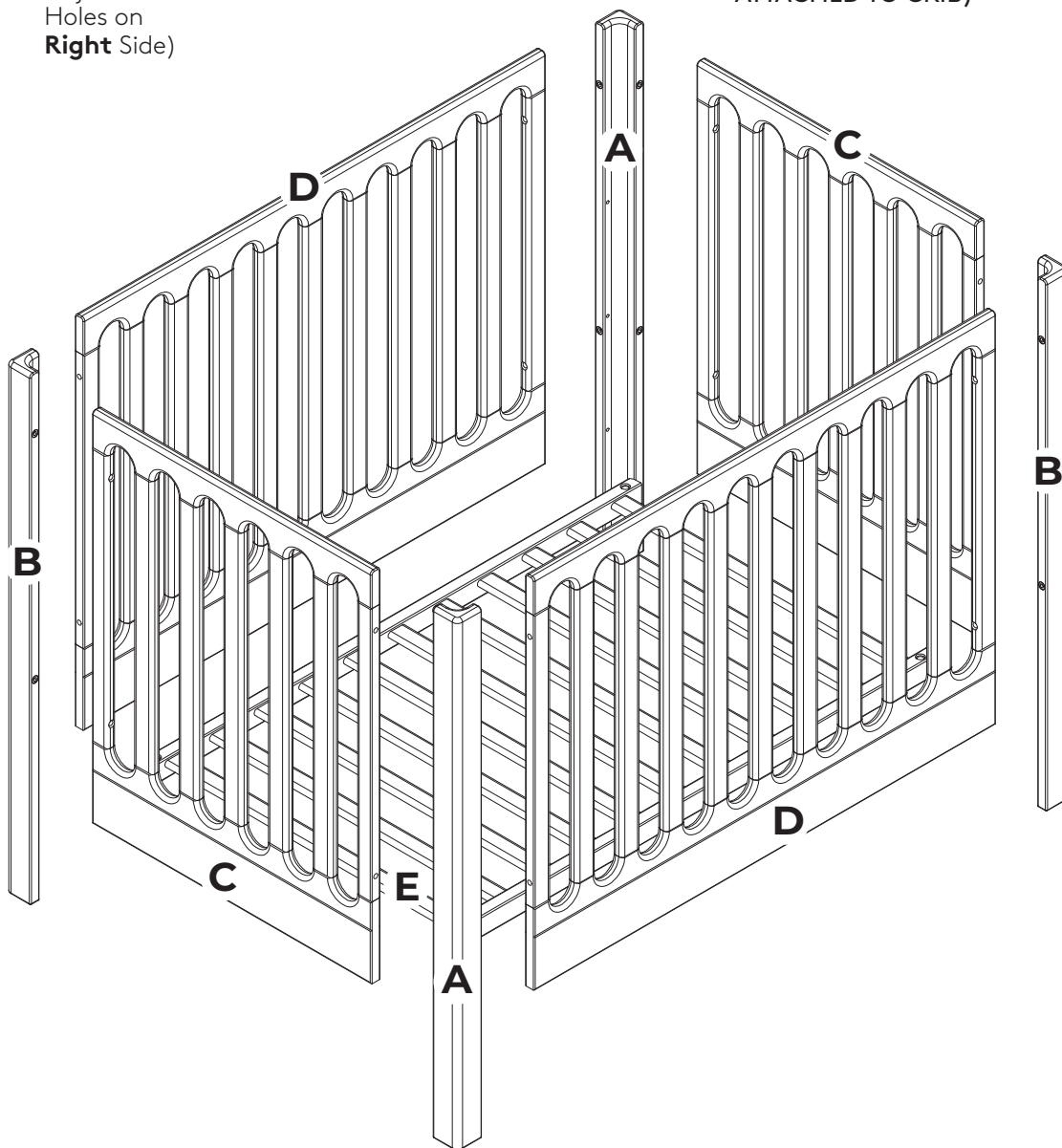

Hardware Actual Size

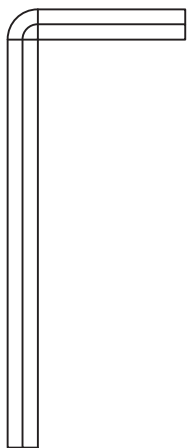

H1 x 1
Allen Wrench



H2 x 16
Bolt 1/4" x L 55



H3 x 4
Bolt 1/4" x L 30

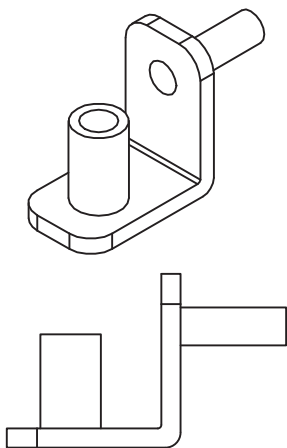

H4 x 4
Bracket

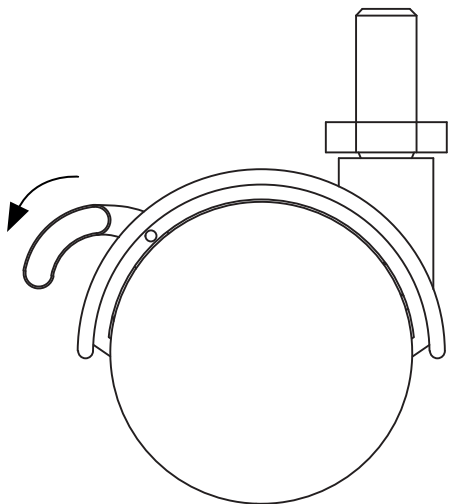

H5 x 4
Optional
Locking Wheel

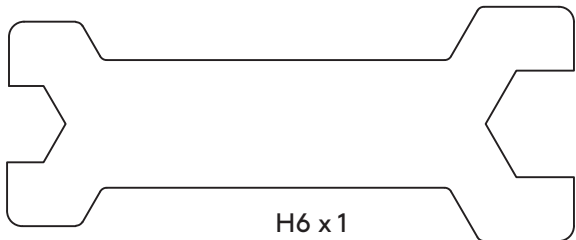
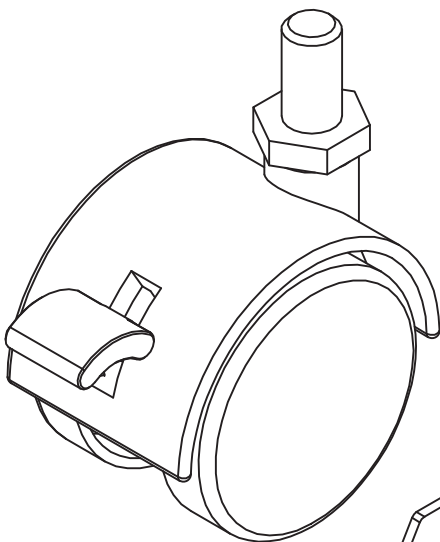

H6 x 1
Flat Wrench

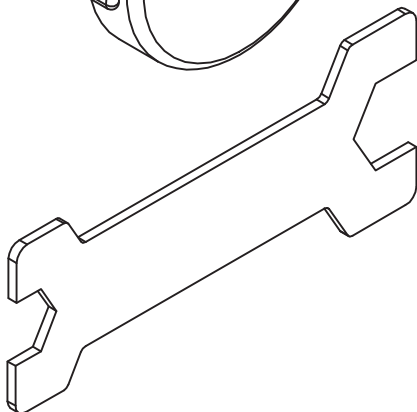

To Assemble the Crib

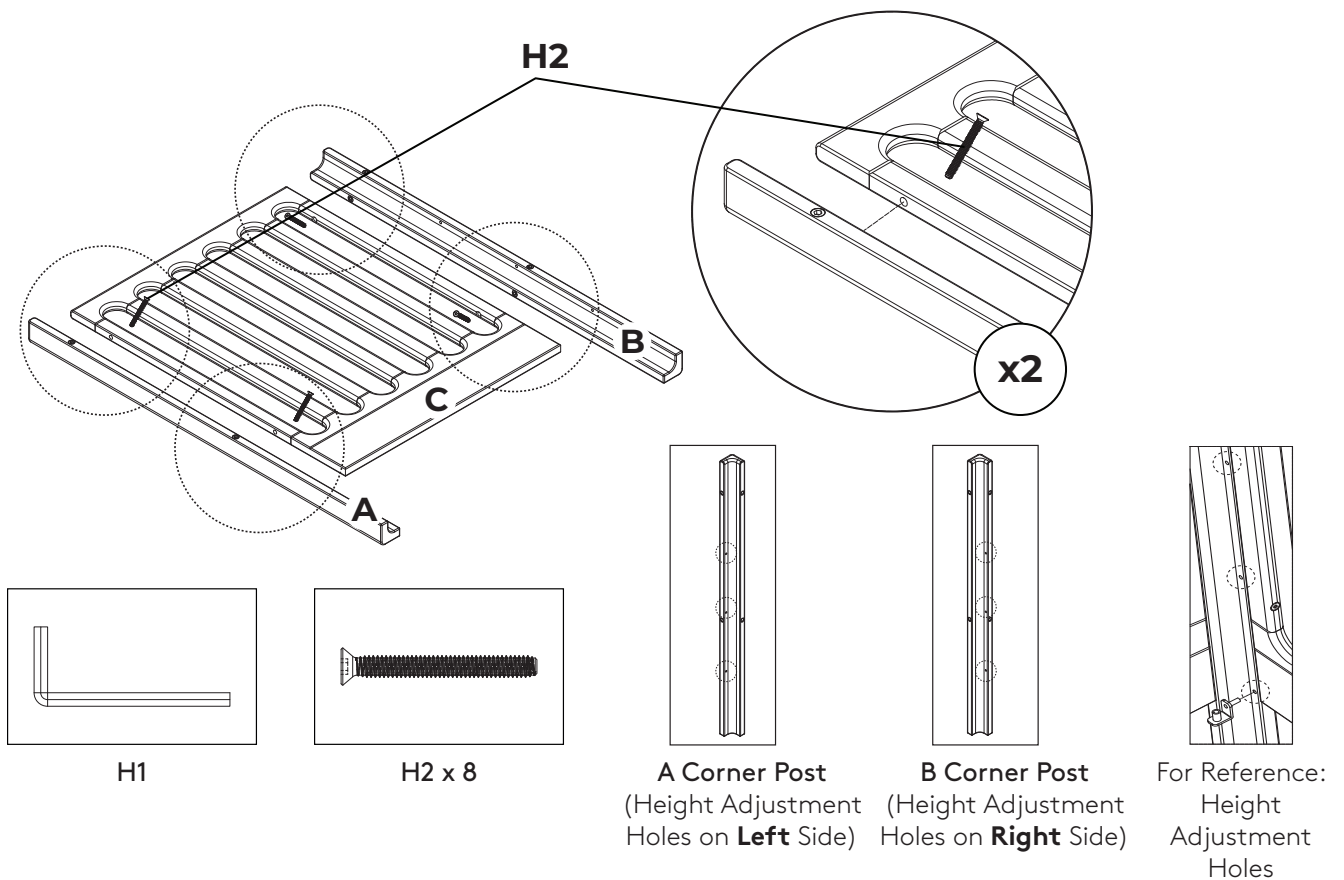

Do not proceed before checking that Corner Post A is on the Left, Corner Post B is on the Right, and Height Adjustment Holes are facing each other across the shorter width of the crib.

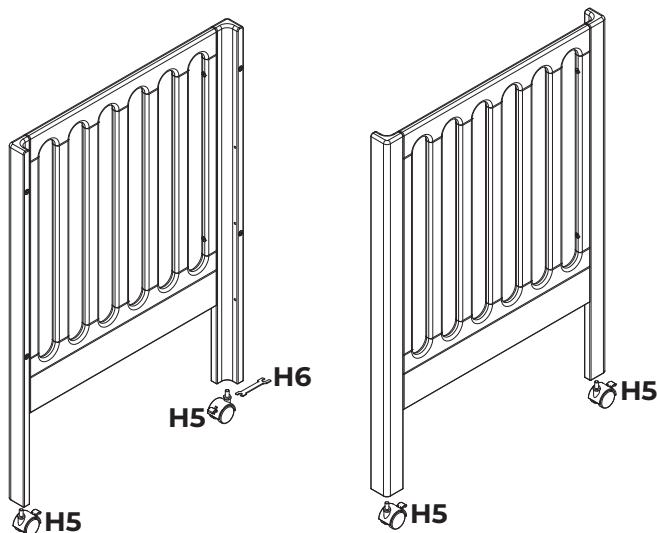

Wheel attachment is optional.

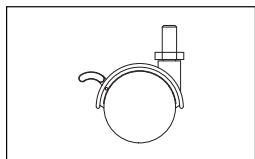

H5 x 4

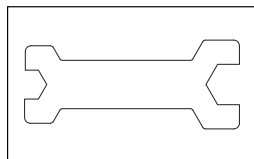

H6

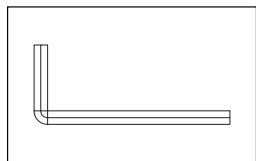
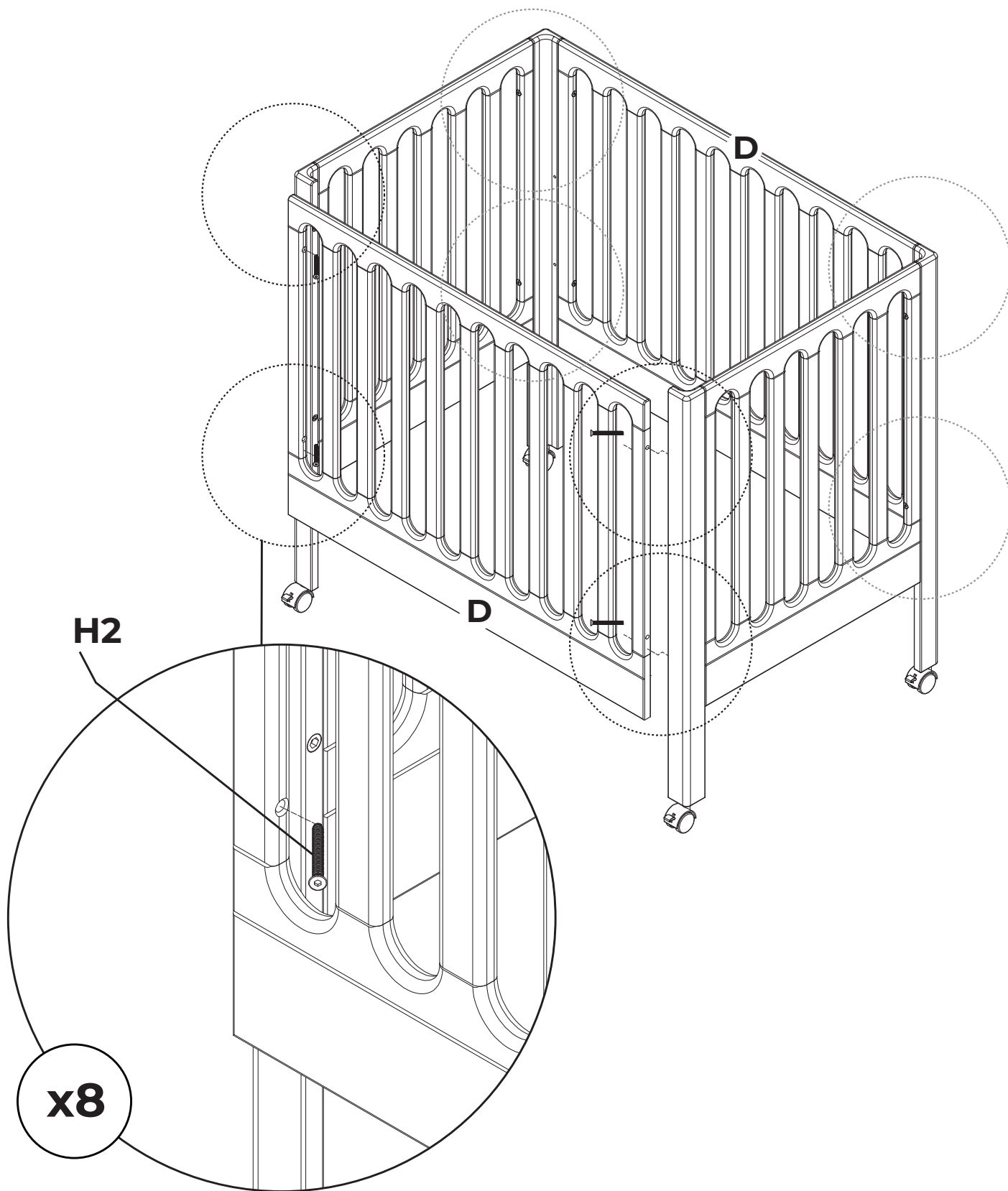

H1

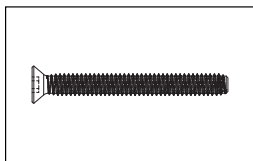

H2 x 8

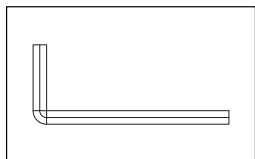
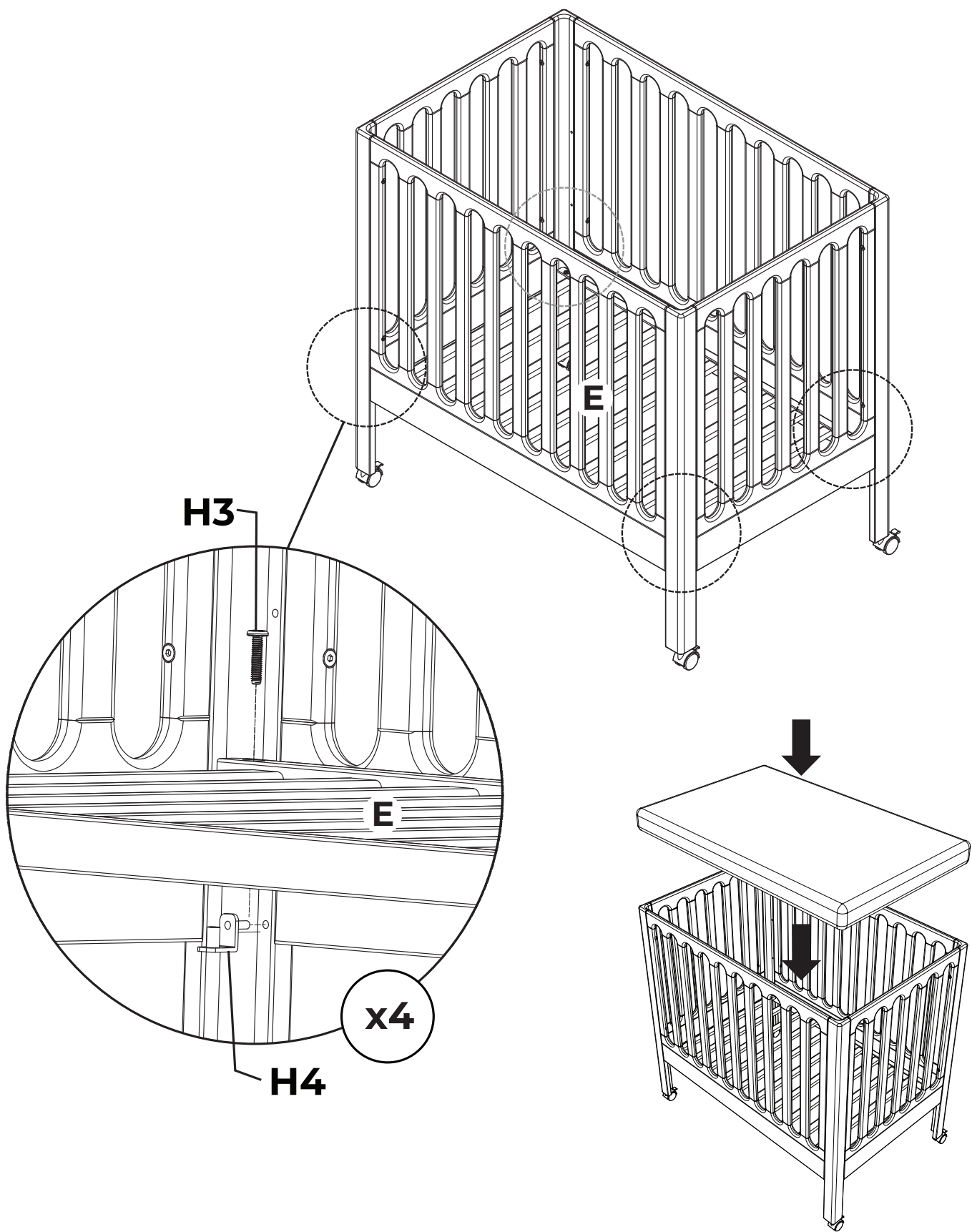

H1

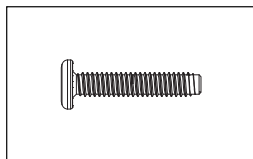

H3 x 4

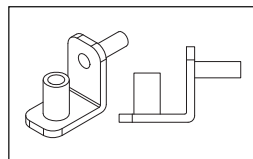

H4 x 4

Mattress Support Height Adjustment

Lower the mattress support and remove the wheels as your infant grows.

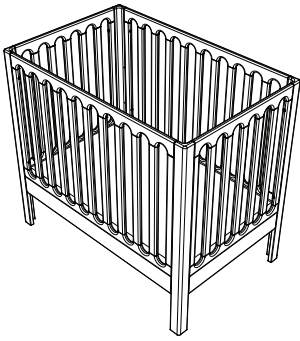
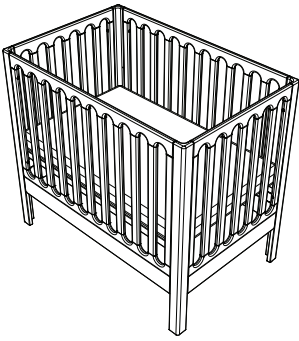
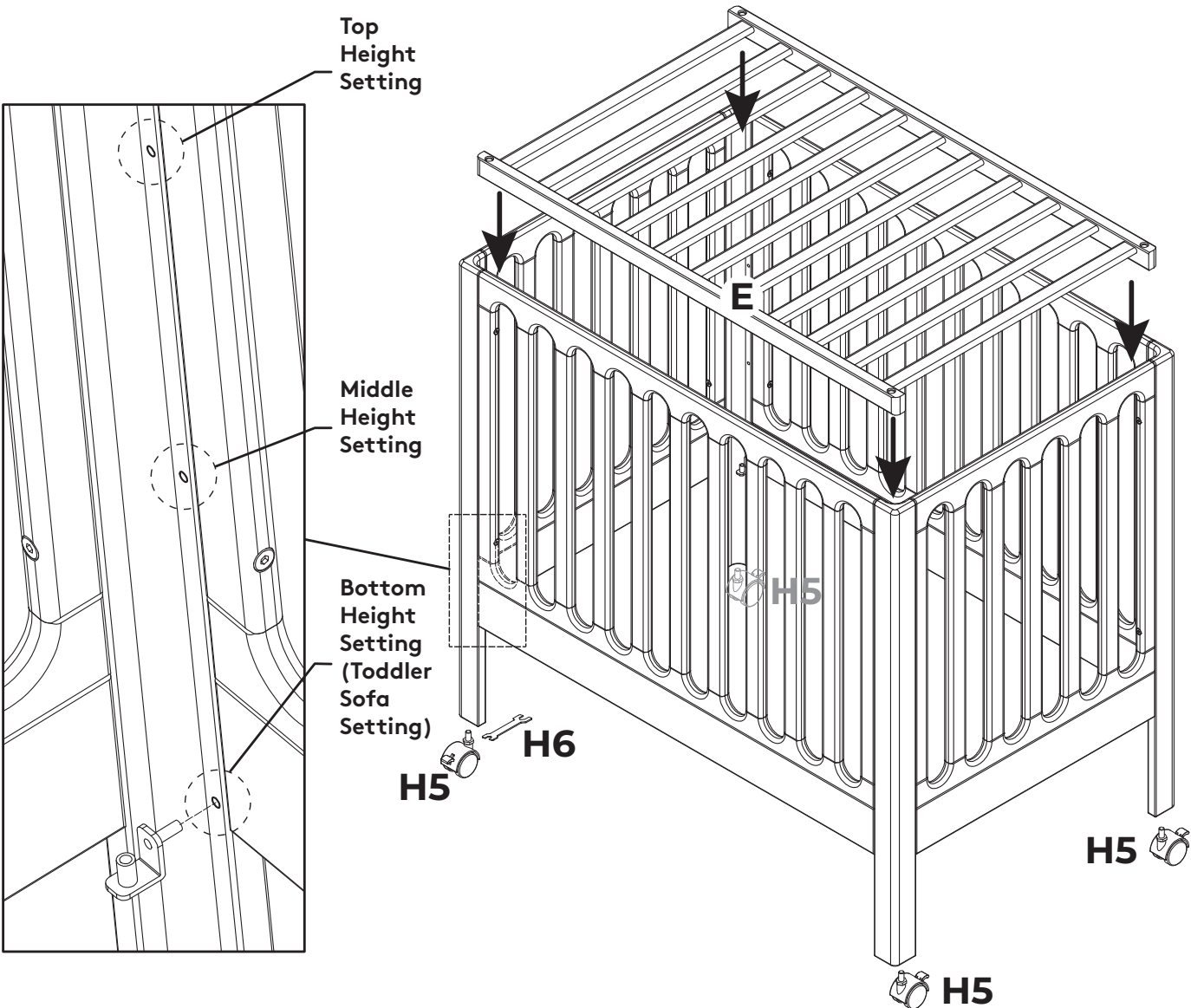

H1

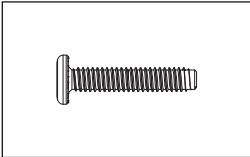

H3 x 4

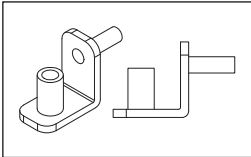

H4 x 4

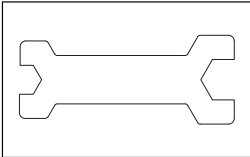

H6

To Assemble the Toddler Sofa

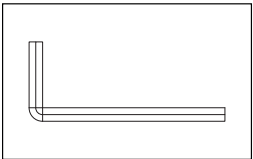
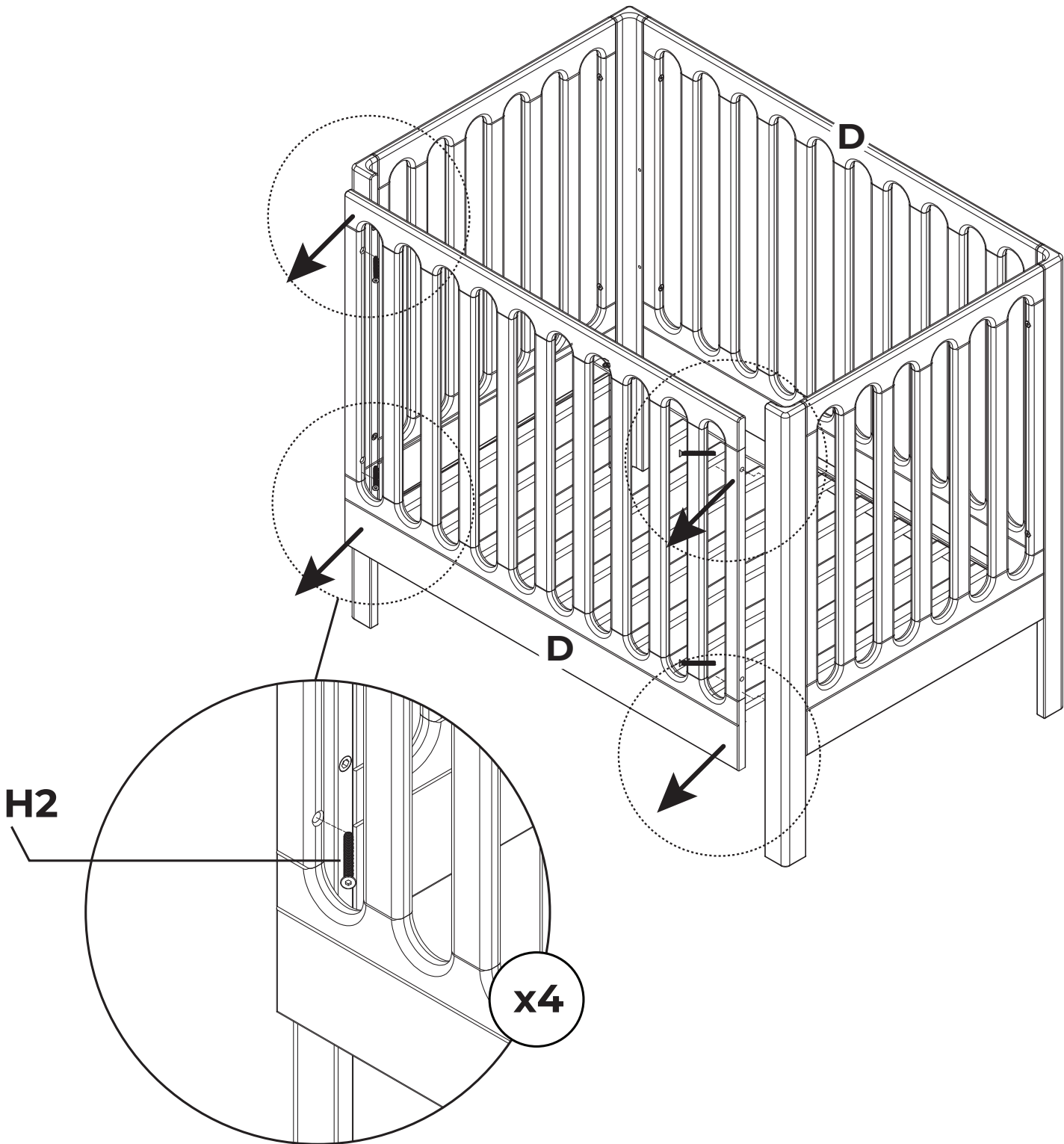

H1

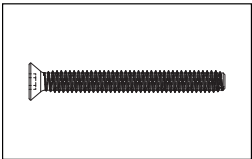

H2 x 4

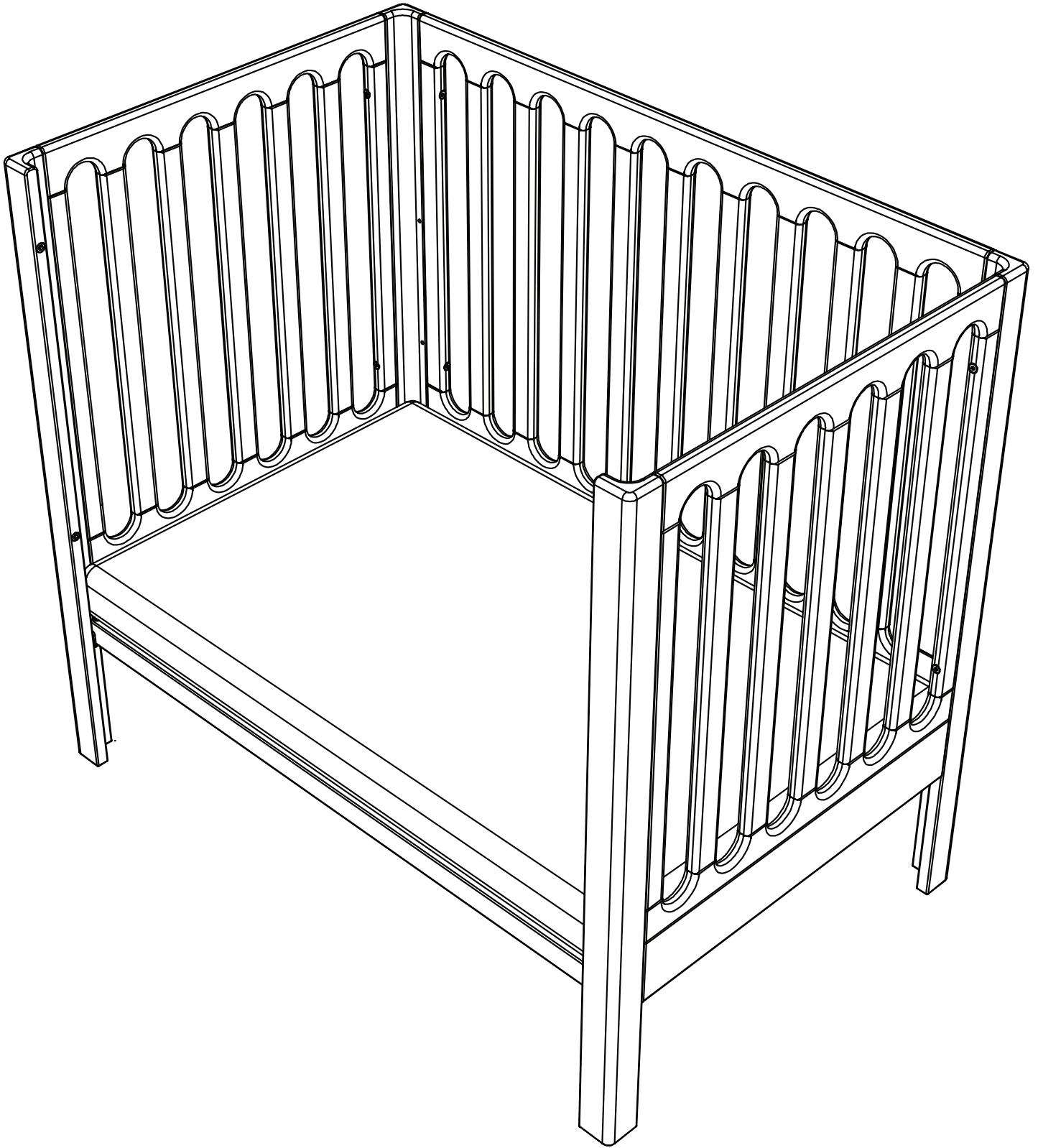

Storage

Store wooden crib in a controlled indoor environment, protected from immoderate temperatures and humidity. Keep away from direct sunlight, air conditioners, radiators, heaters and humidifiers. Major changes in temperature and humidity may result in shrinkage or expansion of wood. Direct sunlight may affect the color over time.

Care and Cleaning

Wipe wood with a soft, lint-free, damp cloth. Use a mild soap only if needed. Then wipe dry immediately with a soft, lint-free dry cloth. Avoid abrasive chemicals and cloths to prevent damage to the surface.

Mini Crib Mattress

Cover Only:

- Zip Fully Closed Prior to Wash + Dry
- Machine Wash Cold, Alone, with Detergent
- To Refresh, Add 1/2 Cup Baking Soda to the Wash
- Tumble Dry Low Thoroughly on Low Heat Setting
- Do NOT Hang Dry

Core Only:

- Hand Rinse Cold (in Shower or Tub)
- Use Mild Detergent
- Shake then Air or Fan Dry
- Avoid Heat or Direct Sun
- Spot Clean as Needed

newton®

382 NE 191st Street
Miami, FL 33179

www.newtonbaby.com
info@newtonbaby.com
800-686-3986